

1981 SPARE PARTS CATALOGUE

MODEL: Mega 2

CHASSIS TYPE:	MC 250/T	Type 350	Engine Type 350
	MC 400/T	Type 351	Engine Type 351
	MC 490/T	Type 352	Engine Type 352

CHASSIS DESCRIPTION

Mega form frame with boxed backbone. 50mm shortened frame profile and 50mm shortened fork slider with 35mm shortened fork tubes. New brake pedal and rear wheel setup. New pipe design. New style fender, side panels, Corte Cosso rebuildable reservoir piggyback shocks 385mm long.

ENGINE DESCRIPTION

Large engine cases with different stud pattern. 490 piston ported engine. 250's are reed valve injection and equipped with 38mm carburetor.

Frame Identification

Stamped on the steering head:

First 3 numbers

350 0000

Engine Identification

Stamped on the engine cases:

First 3 numbers

250 MT 350 0000

400 RT 351 0000

490 RT 352 0000

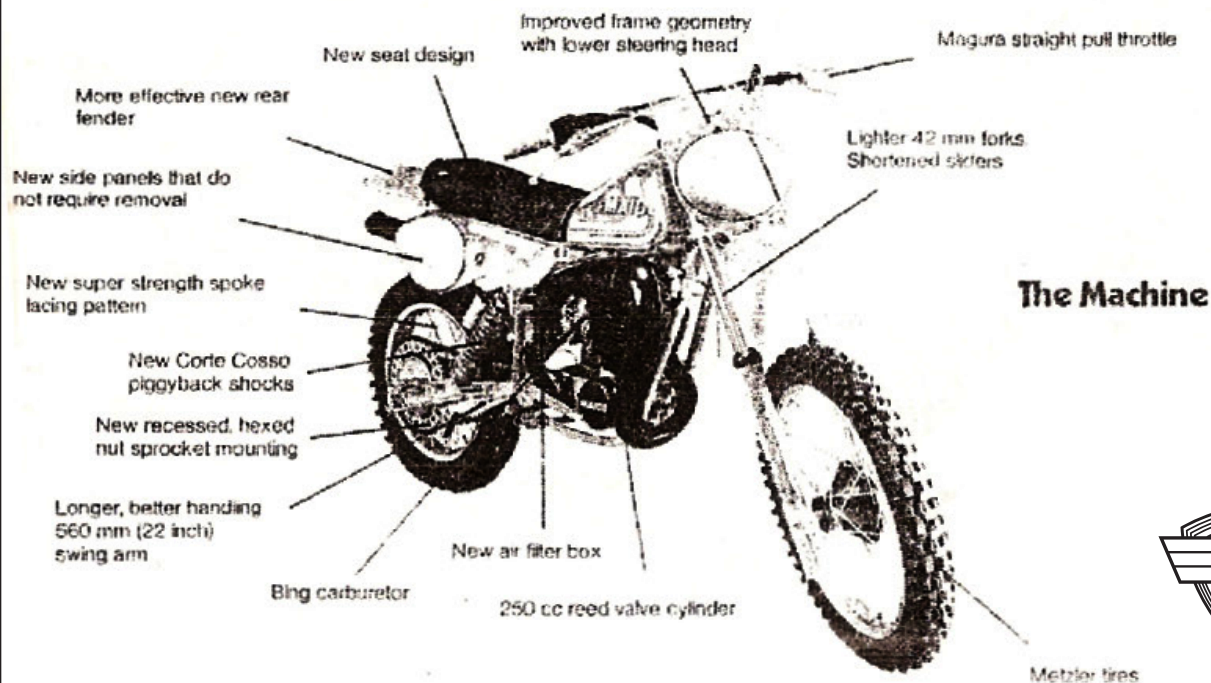

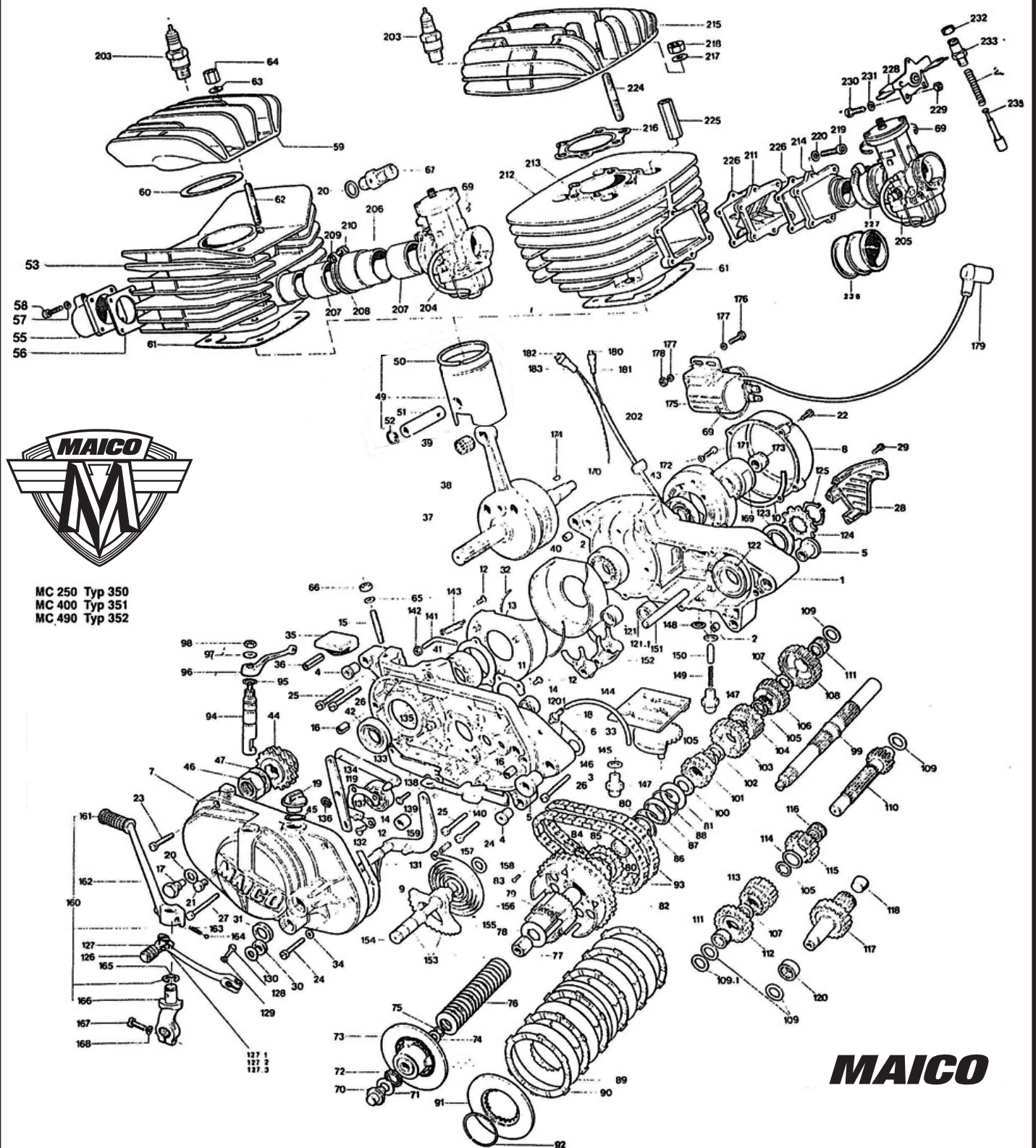

MC 250 Typ 350
MC 400 Typ 351
MC 490 Typ 352

MAICO

EDV No.	Description	MC 250 350	MC 400 351	MC 490 352	Pict. No.	EDV No.	Description	MC 250 350	MC 400 351	MC 490 352
6782	Crankcase right hand	1	1	1	59	6584	Cylinder head	—	1	—
1997	Internal ring	2	2	2	—	6941	Cylinder head	—	—	1
6784	Crankcase left hand	1	1	1	60	720	Cylinder head gasket	—	1	—
1995	Engine mounting bushes	4	4	4	—	6942	Cylinder head gasket	—	—	1
1994	Spacer bush for swing arm	2	2	2	61	6793	Cylinder base gasket 0,3 mm	—	—	—
1993	Crankcase gasket	1	1	1	—	6794	Cylinder base gasket 0,5 mm	1	1	1
2140	Crankcase cover	1	1	1	—	6795	Cylinder base gasket 0,7 mm	—	—	—
1991	Ignition-cover	1	1	1	62	2968	Cylinder head stud	—	5	5
1990	Crankcase cover gasket left hand	1	1	1	63	1745	Washer ϕ 8,2 x 20 x 1,8	—	5	5
1989	Crankcase cover gasket right hand	1	1	1	64	78	Hexagon nut	—	5	5
1988	Main bearing cover plate	1	1	1	65	1714	Spring washer B 8 DIN 137	—	4	4
1795	Counter sunk screw M 5 x 8 DIN 965	11	11	11	66	1670	Hexagon nut M 8 DIN 934	—	4	4
1987	Crankshaft housing	2	—	—	67	517	Decompressions valve cpl.	—	1	1
1986	MS bearing cover plate	2	2	2	68	—	—	—	—	—
1787	Stud screw M 8 x 28 DIN 940	4	4	4	69	6760	Rubber cable clip	2	2	2
1831	Tension pin 8 x 10 DIN 7346	2	2	2	70	5720	Push pin	1	1	1
895	Oil drain plug	1	1	1	71	1096	Bearing plate	1	1	1
1985	Breather	1	1	1	72	1084	Needle cage	1	1	1
1984	Oil filling plug	1	1	1	73	5718	Guide for clutch disc	1	1	1
410	Sealing ring A 14 x 18 DIN 7603	1	1	1	74	2090	Washer 10,1 x 18,2 x 0,6	1	1	1
1526	Cylinder head screw M 8 x 10 DIN 84	1	1	1	75	1842	Securing ring	1	1	1
1536	Cylinder head screw M 6 x 25 DIN 84	4	4	4	76	449	Cup spring	18	18	18
1550	Cylinder head screw M 6 x 30 DIN 84	3	3	3	77	448	Guide nut	1	1	1
1538	Cylinder head screw M 6 x 35 DIN 84	5	5	5	78	447	Lock plate for guide nut	1	1	1
1539	Cylinder head screw M 6 x 40 DIN 84	6	6	6	79	2580	Clutch body	1	1	1
1541	Cylinder head screw M 6 x 50 DIN 84	1	1	1	80	736	Needle cage	2	2	2
1542	Cylinder head screw M 6 x 55 DIN 84	3	3	3	81	444	Thrust washer	1	1	1
1983	Counter sprocket cover	1	1	1	82	6800	Clutch housing with kickstarter ratchet wheel	1	—	—
1533	Cylinder head screw M 6 x 18 DIN 84	3	3	3	—	6900	Clutch housing with kickstarter ratchet wheel	—	—	1
1865	Sealing ring AS 12 x 22 x 7 DIN 3760	1	1	1	83	1906	Oval head rivet 4 x 10 DIN 662	8	8	8
1866	Sealing ring A 18 x 28 x 7	1	1	1	84	729	Kickstarter ratchet wheel	1	1	1
1313	String rubber ϕ 4-280 long	x	—	—	85	730	Kickstarter pinion	1	1	1
263	Breather tube ϕ 4 x 1,5	x	x	x	86	731	Ratchet spring	1	1	1
407	Flat washer A 6 x 10 DIN 7630	2	2	2	87	5592	Spring cup	1	1	1
2133	Sliding piece	1	1	1	88	5593	Circlip	1	1	1
1815	Tension pin 8 x 36 DIN 7346	1	1	1	89	3390	Inner disc	6	6	6
3225	Crankshaft, cpl.	1	—	—	90	3396	Clutch disc	6	6	6
3258	Crankshaft, cpl.	—	1	1	91	5721	Terminal disc	1	1	1
4131	Crankshaft part exchange	1	—	—	92	461	Circlip	1	1	1
4132	Crankshaft part exchange	—	1	1	93	6803	Primary chain	2	2	2
4162	Connecting rod cpl.	—	1	1	94	462	Clutch spindle	1	1	1
4163	Connecting rod cpl.	1	—	—	95	464	Sealing ring for clutch spindle	1	1	1
424	Needle bearing red 0-2	1	1	1	96	2698	Clutch lever	1	1	1
—	Needle bearing blue 2-4	1	1	1	97	1732	Washer B 6,4 DIN 125	1	1	1
—	Needle bearing white 4-6	1	1	1	98	1690	Hexagon nut NM 6 DIN 980	1	1	1
426	Roller bearing NU 305 C 3 DIN 5412	1	1	1	99	2025	Mainshaft	1	1	1
693	Ball bearing 3305 C 3 DIN 628	1	1	1	100	2043	M.s. shim	1	1	1
547	Sealing ring	1	1	1	101	3441	1st gear pinion on mainshaft 19 teeth	1	—	—
3469	Sealing ring	1	—	—	102	3449	1st gear pinion on mainshaft 17 teeth	—	1	1
6826	Sprocket for crankshaft	1	1	1	103	3706	Spacer ring	1	1	1
6827	Sprocket for crankshaft	—	1	1	104	3435	4th gear pinion on mainshaft 25 teeth	1	1	1
1891	Sealing ring for oil filling plug	1	1	1	—	3434	3rd gear pinion on mainshaft 24 teeth	1	—	—
3240	Guide nut on crankshaft	1	1	1	—	3967	3rd gear pinion on mainshaft 23 teeth	—	1	1
3254	Securing plate	1	1	1	105	492	Circlip	3	3	3
6918	Piston 66,95 ϕ cpl.	1	—	—	106	3440	2nd gear pinion on mainshaft 21 teeth	1	—	—
6920	Piston 67,15 ϕ cpl.	1	—	—	—	3448	2nd gear pinion on mainshaft 20 teeth	—	1	1
6921	Piston 67,35 ϕ cpl.	1	—	—	107	3/23	Shim for 1st gear	2	2	2
532	Piston 76,93 ϕ cpl.	—	1	—	108	2039	5th gear pinion on mainshaft 28 teeth	1	1	1
2467	Piston 77,14 ϕ cpl.	—	1	—	*109	3993	Spacer washer	5	5	5
2468	Piston 77,34 ϕ cpl.	—	1	—	110	5597	Layshaft (MT 1)	1	1	1
2072	Piston 77,54 ϕ cpl.	—	1	—	111	913	Needle cage K16 x 21 x 10	2	2	2
2470	Piston 77,74 ϕ cpl.	—	1	—	112	3438	1st gear pinion on layshaft 26 teeth	1	—	—
2471	Piston 77,94 ϕ cpl.	—	1	—	—	3446	1st gear pinion on layshaft 28 teeth	—	1	1
6813	Piston 86,44 ϕ cpl.	—	—	1	113	3442	Twinblock pinion on layshaft 19/21 teeth	1	1	1
6815	Piston 86,64 ϕ cpl.	—	—	1	—	—	—	—	—	—
6816	Piston 86,84 ϕ cpl.	—	—	1	114	3456	Shim for 2nd gear	1	1	1
6817	Piston 87,04 ϕ cpl.	—	—	1	115	3439	2nd gear pinion on layshaft 23 teeth	1	—	—
6818	Piston 87,24 ϕ cpl.	—	—	1	—	3447	2nd gear pinion on layshaft 24 teeth	—	1	1
6819	Piston 87,44 ϕ cpl.	1	—	—	116	3757	Needle cage K20 x 24 x 12	1	1	1
6919	Piston ring 67,00 ϕ	1	—	—	—	—	—	—	—	—
6924	Piston ring 67,20 ϕ	1	—	—	—	—	—	—	—	—
6925	Piston ring 67,40 ϕ	1	—	—	—	—	—	—	—	—
534	Piston ring 77,00 ϕ	—	1	—	—	—	—	—	—	—
2436	Piston ring 77,20 ϕ	—	1	—	—	—	—	—	—	—
2437	Piston ring 77,40 ϕ	—	1	—	—	—	—	—	—	—
2079	Piston ring 77,60 ϕ	—	1	—	—	—	—	—	—	—
2439	Piston ring 77,80 ϕ	—	1	—	—	—	—	—	—	—
2440	Piston ring 78,00 ϕ	—	1	—	—	—	—	—	—	—
6814	Piston ring 86,5 ϕ	—	—	1	—	—	—	—	—	—
6820	Piston ring 86,7 ϕ	—	—	1	—	—	—	—	—	—
6821	Piston ring 86,9 ϕ	—	—	1	—	—	—	—	—	—
6822	Piston ring 87,1 ϕ	—	—	1	—	—	—	—	—	—
6823	Piston ring 87,3 ϕ	—	—	1	—	—	—	—	—	—
6824	Piston ring 87,5 ϕ	—	—	1	—	—	—	—	—	—
535	Piston pin	1	—	1	—	—	—	—	—	—
537	Piston pin	—	1	—	—	—	—	—	—	—
536	Circlip	2	2	2	—	—	—	—	—	—
6891	Radial cylinder cpl.	—	1	—	—	—	—	—	—	—
6938	Radial cylinder cpl.	—	1	—	—	—	—	—	—	—
2159	Cylinder liner	—	—	1	—	—	—	—	—	—
6940	Cylinder liner	—	—	1	—	—	—	—	—	—
6893	Exhaust flange	—	1	1	—	—	—	—	—	—
298	Gasket for exhaust flange	—	1	1	—	—	—	—	—	—
1704	Spring ring B 6 DIN 127	—	4	4	—	—	—	—	—	—
1635	Socket screw M 6 x 25 DIN 912	—	4	4	—	—	—	—	—	—



Pict. No.	EDV No.	Description	350 MC	351 250 MC	352 400 MC	352 490 MC	The Following Part Numbers have been changed and corrected		
							Picture No.	Part No.	Description
117	2037	Drive shaft 28 teeth	1	1	1				
118	2038	Plug	1	1	1				
119	339	Ball bearing 6303 C3 DIN 625	1	1	1				
*120	513	Needle bearing HK 1612	2	2	2				
*121	514	Needle bearing BK 1616	2	2	2				
122	375	Ball bearing 6206 2 RS C3 DIN 625	1	1	1				
123	2044	Spacer ring	1	1	1		120.1	5596	Layshaft bearing left hand
124	3465	Sprocket 13 teeth	—	1	1		121.1	5598	Layshaft bearing right hand
—	3720	Sprocket 14 teeth	1	—	—		109.1	3201	0.8mm shim
125	1848	Lock ring 29 x 1.5 DIN 471	1	1	1		126	6530	Rubber pad
k*127	6585	Gear change lever	1	1	1		127-1	6787	Lever
128	1570	Hexagon screw M 6 x 25 DIN 933	1	1	1		127.3	6588	Screw
129	1726	Spring washer A 6,4 DIN 6798	1	1	1			6589	Spring
130	2324	Washer 12,1 x 26,2 x 1	1	1	1		236	3143	Intake manifold
131	573	Return spring	1	1	1		49	6922	Piston 3rd over size 250
132	6591	Gear change crank	1	1	1			6923	Piston 4th over size 250
133	2336	Pullrod	1	1	1			6929	Piston 5th over size 250
134	2374	Pullrod pivot arm	1	1	1		50	2067	3rd over piston ring 250
135	1903	Pivot pin A 8 x 20 DIN 1469	1	1	1			6927	4th over piston ring 250
136	1836	Securing ring 8 x 0,8 DIN 471	1	1	1			6928	5th over piston ring 250
137	2375	Hooked ratchet sliding arm	1	1	1				
138	2508	Guide plate	1	1	1				
139	1795	Countersunk screw 5 x 8 DIN 955	2	2	2				
140	2510	Hooked ratchet-T 1	1	1	1				
141	2388	Hook	1	1	1				
142	1667	Hexagon nut M 6 DIN 934	1	1	1				
143	576	Tension spring for hooked ratchet	1	1	1				
144	3406	Shifting plate cpl.	1	1	1				
145	3402	Shifting segment	1	1	1				
146	2397	Shim 10,6 x 18,2 x 1	1	1	1				
147	2393	Guide screw	2	2	2				
148	410	Sealing ring A 14 x 18	1	1	1				
149	2395	Tension spring	2	2	2				
150	2396	Pawl pin	1	1	1				
151	2399	Gear selection fork spindle	1	1	1				
152	3414	Gear selection fork	3	3	3				
153	2566	Kickstarter spindle cpl.	1	1	1				
154	2559	Kickstarter spindle	1	1	1				
155	761	Kickstarter quadrant	1	1	1				
156	666	Return spring	1	1	1				
157	1828	Tension bush 5 x 26 DIN 1481	1	1	1				
158	1753	Shim 12,2 x 30,2 x 0,5	1	1	1				
159	3353	Internal ring	1	1	1				
160	5035	Kickstarter lever cpl.	1	1	1				
161	658	Rubber pad	1	1	1				
162	5033	Kickstarter lever	1	1	1				
163	3867	Compressions spring for kickstarter	1	1	1				
164	1874	Ball φ 7	1	1	1				
165	1840	Lock washer	1	1	1				
166	5034	Kickstarter joint	1	1	1				
167	1570	Hexagon screw M 6 x 25 DIN 933	1	1	1				
168	1704	Spring ring B 6	1	1	1				
169	3588	Motoplat ignition cpl.	1	1	1				
170	3530	Rubber sleeve	1	1	1				
171	1630	Socket screw M 5 x 16 DIN 912	3	3	3				
172	1731	Shim B 5,3 DIN 125	3	3	3				
173	1123	Nut for generator	1	1	1				
174	1881	Woodruff key 3 x 3,7 DIN 6888	1	1	1				
175	3600	Ignition coil motoplat	1	1	1				
178	1567	Hexagon screw M 6 x 16 DIN 933	2	2	2				
177	1732	Shim B 6,4 DIN 125	4	4	4				
178	1690	Hexagon nut NM 8 DIN 980	2	2	2				
179	3610	Cable plug	1	1	1				
180	3576	Connector 6,3-1 DIN 46247	1	1	1				
181	3596	Connector housing 6,3	1	1	1				
182	3585	Connector 9,5-8 DIN 46247	1	1	1				
183	3587	Connector housing 9,5	1	1	1				
202	2807	Wirehousing B φ 3 x 0,4 DIN 40621	x	x	x				
203	803	Spark plug Champion N2	1	1	1				
204	6355	Carburetor cpl. Bing V54/40/101/II	—	1	—				
—	6904	Carburetor cpl. Bing V54/40/106/II	—	—	1				
205	6905	Carburetor cpl. Bing V54/38/111/II	1	—	—				
206	6753	Intake flange	—	1	1				
207	5342	Bush	—	1	1				
208	5334	Clamp	—	1	1				
209	620	Screw	—	1	1				
210	621	Nut	—	1	1				
211	6796	Reed valve cpl.	1	—	—				
212	6788	Cylinder 250 cpl.	1	—	—				
213	6789	Cylinder liner φ 67	1	—	—				
214	8866	Intake flange	1	—	—				
215	6791	Cylinder head 250	1	—	—				
216	6792	Cylinder head gasket	1	—	—				
217	1734	Washer B 8,4 DIN 125	6	—	—				
218	1670	Hexagon nut M 8 DIN 934	10	—	—				
219	1635	Socket screw M 6 x 25 DIN 912	6	—	—				
220	1510	Washer B 6 DIN 128	6	—	—				
224	2967	Cylinder head stud	6	—	—				
225	6787	Nut	2	—	—				
226	6810	Intake gasket	2	—	—				
227	883	Clamp	1	—	—				
228	6912	Choke lever	1	—	—				
229	6914	nut	2	—	—				
230	6913	screw	2	—	—				
231	1509	Washer	2	—	—				
232	6911	Rubber cap	1	—	—				
233	6910	Choke housing	1	—	—				
234	6909	Spring	1	—	—				
235	6808	Choke piston	1	—	—				



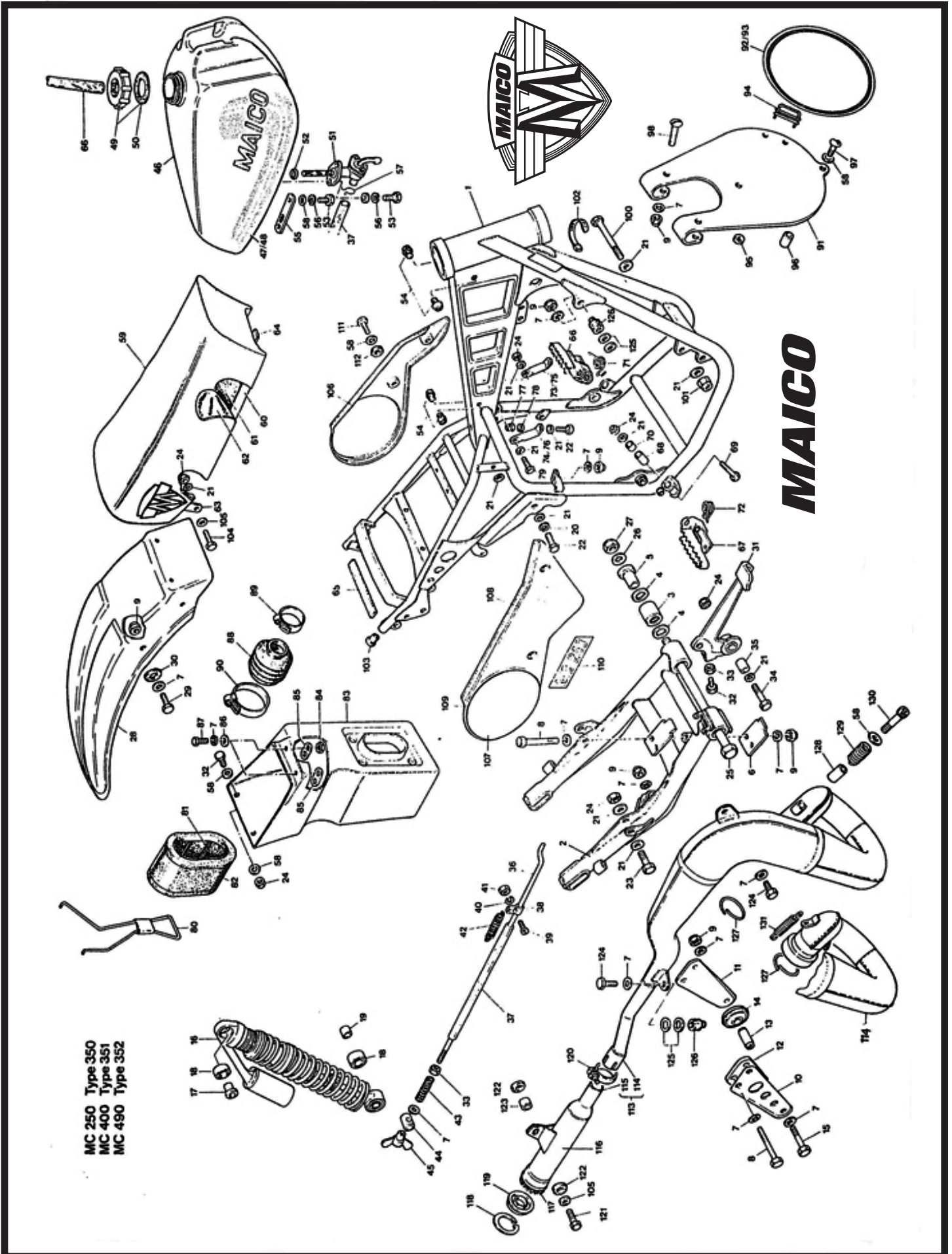

MC 250 Type 350
MC 400 Type 351
MC 490 Type 352

Pict. No.	EDV No.	Description	MC 250			MC 400			MC 490		
			350	351	352	350	351	352	350	351	352
1	6627	Frame cpl.	1	1	1						
2	6651	Swing arm	1	1	1						
3	3932	Needle cage HK 2030	2	2	2						
4	1930	O-ring	4	4	4						
5	1931	Swing arm bush	2	2	2						
6	1932	Guide plate	2	2	2						
7	1732	Washer B 6,4 DIN 125	30	30	30						
8	1575	Hexagon screw M6 x 60 DIN 931	3	3	3						
9	1690	Hexagon nut NM 6 DIN 980	13	13	13						
10	1933	Chain guide right	1	1	1						
11	1934	Chain guide left	1	1	1						
12	1935	Plastic guide	2	2	2						
13	1936	Bush for roller	3	3	3						
14	1937	Roller	2	2	2						
15	1500	Hexagon screw M6 x 40 DIN 931	1	1	1						
16	6650	Damper cpl.	2	2	2						
	6775	Spring set black - hard	nB	nB	nB						
	6777	Spring set gold - soft	nB	nB	nB						
	6765	Spring set red - medium	nB	nB	nB						
	6773	Set piston shaft BE-sand	nB	nB	nB						
	6767	Set piston shaft 2H - GP	nB	nB	nB						
	6772	Set piston shaft 5 G - Enduro	nB	nB	nB						
17	6658	Bush	2	2	2						
18	6659	Silentbloc	4	4	4						
19	6679	Bush	2	2	2						
20	1705	Spring ring B 8 DIN 127	2	2	2						
21	1734	Washer B 8,4 DIN 125	23	23	23						
22	1594	Hexagon screw M8 x 40 DIN 931	4	4	4						
23	1595	Hexagon screw M8 x 45 DIN 931	2	2	2						
24	1692	Securing nut NM 8 DIN 980	6	6	6						
25	3937	Swing arm spindle	1	1	1						
26	1718	Spring washer B 14 DIN 137	1	1	1						
27	5011	Nut NM 14 x 1,5 DIN 980	1	1	1						
28	6668	Rear fender	1	1	1						
29	1558	Hexagon screw M6 x 18 DIN 933	4	4	4						
30	2708	Rubber washer	4	4	4						
31	6699	Brake lever	1	1	1						
32	1569	Hexagon screw M6 x 20 DIN 933	3	3	3						
33	1667	Hexagon nut M6 DIN 934	2	2	2						
34	1599	Hexagon screw M8 x 60 DIN 931	1	1	1						
35	6702	Bush for brake lever	1	1	1						
36	6703	Rear brake rod	1	1	1						
37	406	Hose	x	x	x						
38	237	Clamp	1	1	1						
39	1527	Cylinder head screw M4 x 10 DIN 84	1	1	1						
40	1702	Spring ring B 4 DIN 127	1	1	1						
41	1665	Hexagon nut M4 DIN 934	1	1	1						
42	236	Extension spring	1	1	1						
43	242	Compression spring	1	1	1						
44	244	Nipple holder	1	1	1						
45	243	Wing nut	1	1	1						
46	6713	Tank with decal	1	1	1						
47	6714	Tank decal left	1	1	1						
48	6715	Tank decal right	1	1	1						
49	6515	Tank cap cpl.	1	1	1						
50	6516	Sealing ring	1	1	1						
51	6509	Pet cock	1	1	1						
52	6510	O-ring	1	1	1						
53	1525	Hexagon screw M6 x 14 DIN 933	4	4	4						
54	6531	Rubber stop	4	4	4						
55	6511	Holding plate for tank	1	1	1						
56	1704	Spring ring B6 DIN 127	4	4	4						
57	2832	Hose clip	2	2	2						
58	1750	Washer B 6,4 DIN 9021	12	12	12						
59	6723	Seat cpl.	1	1	1						
	6726	Seat cpl. high	nB	nB	nB						
	6720	Seat base	1	1	1						
	6724	Seat foam	1	1	1						
	6727	Seat foam high	nB	nB	nB						
	6725	Seat cover, low	1	1	1						
	6728	Seat cover high	nB	nB	nB						
	6721	Seat bracket	1	1	1						
	6722	Clamp holder for seat	1	1	1						
	6759	Rubber strap, adhesive	x	x	x						
	6731	Foot peg left	1	1	1						
	6735	Foot peg right	1	1	1						
	6738	Bush for foot peg	2	2	2						
	1597	Hexagon screw M8 x 55 DIN 931	2	2	2						
	6750	Spacer bush	2	2	2						
	6739	Foot peg spring left	1	1	1						
	6740	Foot peg spring right	1	1	1						
	6741	Cylinder head stay left	1	-	-						
	6742	Cylinder head stay right	1	-	-						
	6660	Cylinder head stay left	-	1	1						
	6661	Cylinder head stay right	-	1	1						
	78	Hexagon nut long M8, 14 mm	2	2	2						
	1511	Spring ring B 8 DIN 128	2	2	2						
	1589	Hexagon screw M 8 x 20 DIN 933	2	2	2						
	6540	Holding wire	1	1	1						
	6544	Air filter cage	1	1	1						
82	6545	Air filter foam	1	1	1						
83	6743	Air box	1	1	1						
84	1690	Hexagon nut NM 6 DIN 980	4	4	4						
85	6729	Hook	2	2	2						
86	3529	Washer	2	2	2						
87	1570	Hexagon screw M6 x 25 DIN 933	2	2	2						
88	343	Intake manifold	1	1	1						
89	683	Clamp	1	1	1						
90	348	Clamp	1	1	1						
91	6555	Front no. panel	1	1	1						
92	6252	Number plate decal, green front	1	-	-						
93	6261	Number plate decal, yellow front	-	1	1						
94	6247	Cable guide	1	1	1						
95	6265	Spring nut	2	2	2						
96	3094	Sliding roller	2	2	2						
97	6253	Plastic screw M6 x 30	2	2	2						
98	3711	Plastic screw M6 x 22	2	2	2						
99	6254	Set motormount belts, parts of pict. no. 100,4 x 21, 101	1	1	1						
100	1610	Hexagon screw, M6 x 120 DIN 931	2	2	2						
101	1700	Nut NM 8 DIN 980	2	2	2						
102	325	Rubber cable clip	8	8	8						
103	6565	Rubber plug	2	2	2						
104	1587	Hexagon screw M8 x 16 DIN 933	2	2	2						
105	1759	Washer B 8,4 DIN 9021	3	3	3						
106	6746	Side panel left	1	1	1						
107	4153	Green number plate decal	2	-	-						
	4152	Yellow no. plate decal	-	2	2						
108	6752	Decal right	1	1	1						
	6730	Decal left	1	1	1						
109	6749	Side panel right	1	1	1						
110	6747	Sticker 250	1	-	-						
	6663	Sticker 400	-	1	1						
	6755	Sticker 490	-	-	1						
111	5050	Screw M6 x 16 DIN 7985	4	4	4						
112	2706	Rubber washer	4	4	4						
113	6860	Exhaust system cpl.	1	-	-						
	6856	Exhaust system cpl.	-	1	1						
114	6861	Exhaust system	1	-	-						
	6844	Exhaust system	-	1	1						
115	6862	Silencer cpl.	1	-	-						
	6850	Silencer cpl.	-	1	1						
116	6863	Silencer	1	-	-						
	6846	Silencer	-	1	1						
117	6864	Exhaust packing	1	-	-						
	6851	Exhaust packing	-	1	1						
118	1894	Securing ring 70 x 2,5 DIN 472	1	1	1						
119	6852	Silencer end cap	1	1	1						
120	5474	Clamp S 35/15	1	1	1						
121	1591	Hexagon screw M8 x 25 DIN 933	1	1	1						
122	5345	Rubber washer	2	2	2						
123	5453	Bush for exhaust mount	1	1	1						
124	1567	Hexagon screw M6 x 16 DIN 933	2	2	2						
125	5430	Asbestos washer	4	4	4						
126	1166	Silentbloc for exhaust	2	2	2						
127	896	Asbestos cord	x	x	x						
128	6276	Silence for exhaust spring	-	1	1						
129	6275	Spring for exhaust	-	1	1						
130	1523	Socket screw M6 x 70 DIN 912	-	1	1						
131	6966	Spring for exhaust	2	-	-						



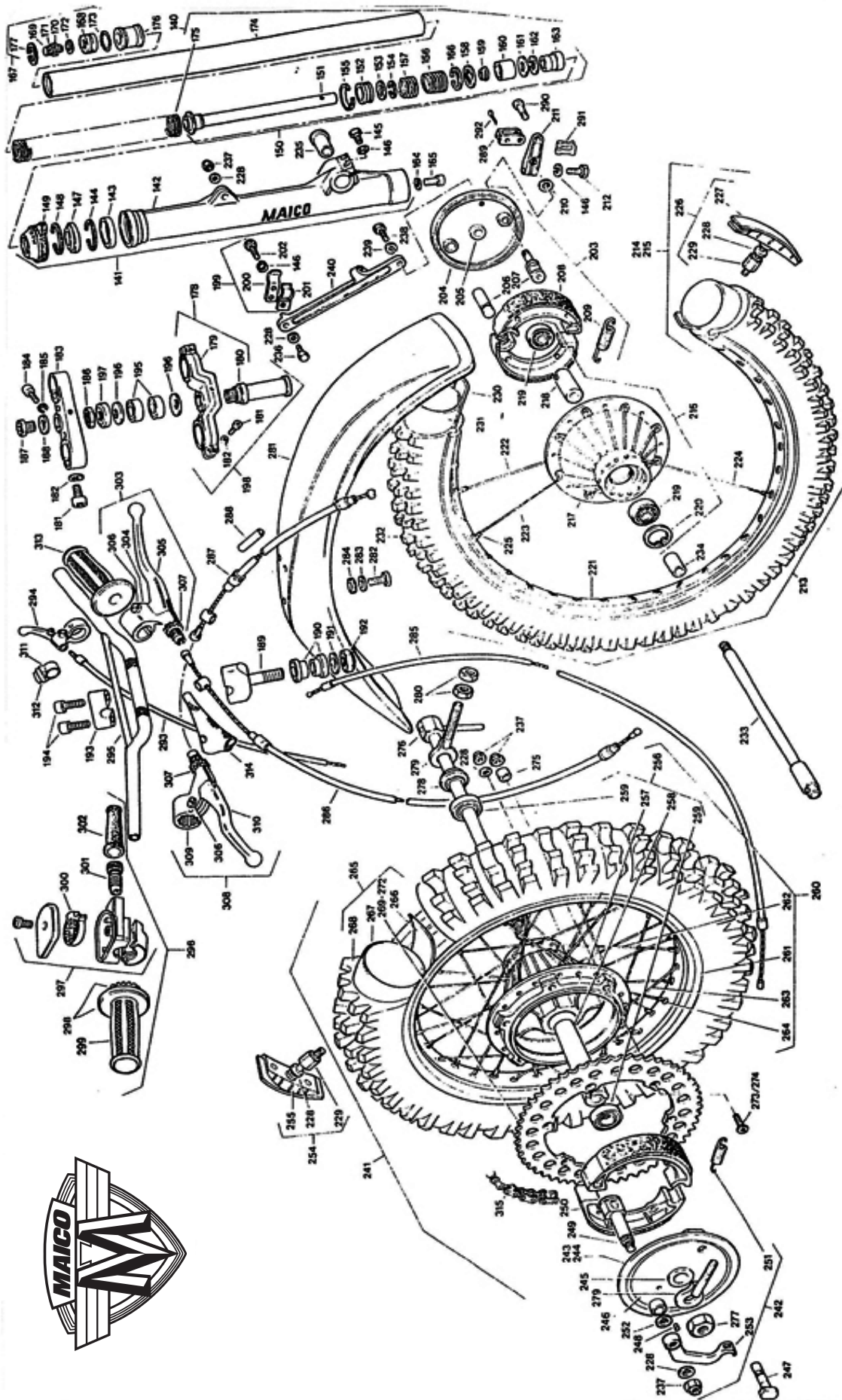

Pict. No.	EDV No.	Description	MC 250 350	MC 400 351	MC 490 352	Pict. No.	EDV No.	Description	MC 250 350	MC 400 351	MC 490 352
140	6636	Fork leg	2	2	2	245	183	Spacer bush	2	2	2
141	6631	Fork slider cpl.	2	2	2	246	6709	Cover plate	1	1	1
142	6630	Fork slider	2	2	2	247	6710	Pivot bolt	1	1	1
143	6436	Guide bush	2	2	2	248	1901	Oval head nail ϕ 3 x 8 DIN 1476	1	1	1
144	6437	Circlip SB 46	2	2	2	249	151	Brake toggle	1	1	1
145	1571	Hexagon screw M6 x 30 DIN 931	4	4	4	250	188	Brake shoe	2	2	1
146	1510	Spring ring B 6 DIN 128	6	6	6	251	6148	Tension spring	2	2	2
147	6439	Seal	2	2	2	252	187	Rubber washer	1	1	1
148	6440	Circlip SB 55 x 1,5	2	2	2	253	3190	Rear brake lever	1	1	1
149	6441	Wiper	2	2	2	254	2434	Tire holder rear cpl.	1	1	1
150	6635	Damper cpl	2	2	2	255	2567	Tire holder plate	1	1	1
151	6632	Damper tube	2	2	2	256	6684	Rear hub cpl.	1	1	1
152	9447	Damper piston	2	2	2	257	6689	Rear hub	1	1	1
153	6448	Washer 23,9 x 28,2 x 0,9	2	2	2	258	3276	Spacer tube	1	1	1
154	6449	Circlip SW 24	2	2	2	259	205	Ball bearing 6303 2 RS C 3	2	2	2
155	6450	Piston ring	2	2	2	260	6685	Rear wheel	1	1	1
156	6452	Stop spring soft	2	2	2	261	6686	Akront rim 18"	1	1	1
157	6460	Stop spring hard	2	2	2	262	6687	Spoke rear M 4,5 x 209	18	18	18
158	6426	Valve seat	2	2	2	263	6688	Spoke rear M 4,5 x 163	18	18	18
159	6454	Valve	2	2	2	264	2408	Nipple M 4,5	36	36	36
160	6427	Damper insert	2	2	2	265	6690	Rear wheel with tire	1	1	1
161	6456	Washer 29,9 x 36,7 x 0,2	2	2	2	266	2005	Rim Strap 18"	1	1	1
162	6457	Securing ring 37 x 1,5 DIN 472	2	2	2	268	2008	Tire 4.50-18"	1	1	1
163	6458	Bush for damper	2	2	2	267	2015	Tube 4.50-18"	1	1	1
164	6459	Seal ring A 10 x 15 DIN 7603	2	2	2	269	6692	Sprocket 50 T	nB	nB	nB
165	1655	Socket screw M10 x 25 DIN 6912	2	2	2	270	6693	Sprocket 52 T	nB	nB	nB
166	6428	Circlip SB 38	2	2	2	271	6694	Sprocket 54 T	nB	nB	nB
167	6429	Fork cap cpl.	2	2	2	272	6695	Sprocket 56 T	nB	nB	nB
168	6431	Fork cap	2	2	2	273	1880	Rear sprocket bolt M 8 x 50 DIN 7991	3	3	3
169	2184	Valve cpl.	2	2	2	274	1803	Rear sprocket bolt M 8 x 40 DIN 7991	3	3	3
170	2186	Valve insert	2	2	2	275	6696	Bush for sprocket bolt	3	3	3
171	2187	Valve cap	2	2	2	276	3277	Rear axle	1	1	1
172	277	Seal ring A 8 x 11,5 DIN 7603	2	2	2	277	1709	Securing nut NM 16 x 1,5 DIN 980	1	1	1
173	6464	O-ring 29,74 x 3,53	2	2	2	278	3196	Spacer ring	1	1	1
174	6637	Fork tube	2	2	2	279	6705	Chain adjuster	2	2	2
175	6629	Fork spring	2	2	2	280	1670	Nut M 8 DIN 934	4	4	4
176	6628	Spacer tube	2	2	2	281	6493	Front fender	1	1	1
177	6457	Securing ring 37 x 1,5 DIN 472	2	2	2	282	1569	Hexagon screw M 6 x 20 DIN 933	4	4	4
178	6639	Lower cross head cpl.	1	1	1	283	1750	Washer 6,4 DIN 9021	4	4	4
179	6640	Lower cross head	1	1	1	284	2708	Rubber washer	4	4	4
180	6471	Steering tube	1	1	1	285	2456	Throttle cable	1	1	1
181	3270	Socket screw M10 x 40 DIN 6912	4	4	4	286	6150	Clutch cable cpl.	1	1	1
182	1512	Spring ring B 10 DIN 128	4	4	4	287	6530	Brake cable	1	1	1
183	6473	Upper cross head	1	1	1	288	2275	Hose B 8 x 0,7 DIN 40621	x	x	x
184	1648	Socket screw M 8 x 40 DIN 912	1	1	1	289	6151	Cable holder	1	1	1
185	1511	Spring ring B8 DIN 128	1	1	1	290	6152	Bolt	1	1	1
186	6474	Steering head nut	1	1	1	291	6153	Clip for bolt	1	1	1
187	6475	Screw plug	1	1	1	292	1857	Splint pin 3,2 x 25 DIN 94	1	1	1
188	6476	Washer B 23 DIN 125	1	1	1	293	315	Decompressor cable	-	1	1
189	6477	Handle bar clamp low	2	2	2	294	148	Lever for decompressor	-	1	1
190	15	Rubber buffer	4	4	4	295	6668	Handlebar	1	1	1
191	6642	Washer	2	2	2	296	6280	Throttle grip cpl.	1	1	1
192	1693	Nut NM 10 DIN 980	2	2	2	299	2148	Rubber grip	1	1	1
193	6478	Upper handle bar clamp	2	2	2	301	2211	Adjusting screw	1	1	1
194	1628	Socket screw M8 x 25 DIN 6912	4	4	4	302	2212	Rubber cap	1	1	1
195	3297	Tapered roller bearing	2	2	2	303	2215	Hand clutch lever cpl.	1	1	1
196	3296	Nilos-ring	2	2	2	304	2213	Hinge for clutch lever	1	1	1
197	6480	Cover tray	1	1	1	305	2216	Clutch lever blade	1	1	1
198	6641	Fork cpl.	1	1	1	306	133	Lever screw with nut	2	2	2
199	6257	Cable holder cpl.	1	1	1	307	212	Adjusting screw with nut	2	2	2
200	6258	Cable clamp	1	1	1	308	2218	Hand brake lever cpl.	1	1	1
201	6255	Cable clamp	1	1	1	309	2217	Hinge for brake lever	1	1	1
202	1565	Hexagon screw M6 x 12 DIN 933	1	1	1	310	2219	Hand brake lever	1	1	1
203	6144	Front brake plate cpl.	1	1	1	311	2220	Kill button	1	1	1
204	2236	Front brake plate with bush	1	1	1	313	2512	Rubber grip	1	1	1
205	2238	Bushing	1	1	1	314	2204	Lever cover red	2	2	2
206	2418	Pivot bolt	1	1	1	315	6744	Chain	1	1	1
207	2419	Brake toggle	1	1	1						
208	1322	Brake shoe	2	2	2						
209	6146	Spring for brake shoe	2	2	2						
210	187	Rubber washer	1	1	1						
211	6145	Brake arm front	1	1	1						
212	1570	Hexagon screw M6 x 25 DIN 933	1	1	1						
213	6678	Front wheel cpl.	1	1	1						
214	6677	Front wheel with tire	1	1	1						
215	6672	Front wheel	1	1	1						
216	6671	Front hub cpl.	1	1	1						
217	6670	Front hub	1	1	1						
218	2428	Spacer tube	1	1	1						
219	2427	Ball bearing 6202 RS DIN 625	2	2	2						
220	1853	Securing ring 35 x 1,5 DIN 472	1	1	1						
221	6673	Akront-rim 21"	1	1	1						
222	6674	Front spoke M 4 x 227 - 80°	9	9	9						
223	6675	Front spoke M 4 x 227 - 100°	9	9	9						
224	6676	Front spoke M 4 x 244 - 115°	18	18	18						
225	2242	Nipple 4,5 M 4	36	36	36						
226	168	Tire holder front cpl.	1	1	1						
227	2568	Tire holder plate	1	1	1						
228	1734	Washer B 8,4 DIN 125	8	8	8						
229	289	Nut for tire holder	2	2	2						
231	2002	Tube 3.00-21"	1	1	1						
230	2001	Rim strab 21"	1	1	1						
232	2003	Tire 3.00-21"	1	1	1						
233	2247	Front axle	1	1	1						
234	2250	Spacer bush	1	1	1						
235	2430	Threaded bush	1	1	1						
236	1594	Hexagon screw M 8 x 40 DIN 931	1	1	1						
237	1692	Nut NM 8 DIN 980	8	8	8						
238	1589	Hexagon screw M 8 x 20 DIN 933	1	1	1						
239	1714	Spring washer B 8 DIN 137	1	1	1						
240	6147	Brake stay	1	1	1						
241	6691	Rear wheel cpl.	1	1	1						
242	6711	Brake plate cpl.	1	1	1						
243	6707	Brake plate with pressed parts	1	1	1						
244	6708	Brake plate	1	1	1						

x = yard goods
nB = as required

